

## UT - kołki zgrzewane bez gwintu

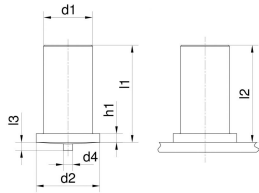

d1 ±0.1	Stal polerowana miedzią	Stal nierdzewna Seria 300	Aluminium	Mosiądz	l1	d2 ±0.2	d4 ±0.08	l3 ±0.05	h1	l2
3	UT-1-03-XX	UT-2-03-XX	UT-4-03-XX	UT-3-03-XX	6 – 30	4.5	0.6	0.55	0,7 – 1,4	≈ l1 - 0,3
4	UT-1-04-XX	UT-2-04-XX	UT-4-04-XX	UT-3-04-XX	6 – 40	5.5	0.65	0.55	0,7 – 1,4	≈ l1 - 0,3
5	UT-1-05-XX	UT-2-05-XX	UT-4-05-XX	UT-3-05-XX	6 – 45	6.5	0.75	0.8	0,7 – 1,4	≈ l1 - 0,3
6	UT-1-06-XX	UT-2-06-XX	UT-4-06-XX	UT-3-06-XX	8 – 60	7.5	0.75	0.8	0,7 – 1,4	≈ l1 - 0,3
7.1	UT-1-07-XX	UT-2-07-XX	UT-4-07-XX	UT-3-07-XX	10 – 60	9	0.75	0.85	0,8 – 1,4	≈ l1 - 0,3